



LINEPROOF[®]
ENGINEERING INDIA PVT. LTD.



SERIES ANSI LP300



we are loyal to our customers...

www.lineproofengg.com



SERIES ANSI LP300

Mechanical Seals / Mechanical Seals for Pump / Standard Cartridge Seals ANSI Mechanical Seal



Product variants

LP300 ASTN and -ABTN
Single seal standard (S) and big bore (B) seal chambers.
Same as LPSC300 but with throttle ring
(item 16) at the atmospheric side. The cover has auxiliary
connections for flushing and quench.
Throttle ring: PTFE carbon-graphite reinforced (T12)

LP300 ASQN and -ABQN
Single seal for operation with unpressurized quench for
standard (S) and big bore (B) seal chambers. Same as
LPSC300 version but with lip seal (item
16) at the atmospheric side. The cover has auxiliary
connections for flushing and quench.
Lip seal: NBR (P), PTFE carbon reinforced (T3)

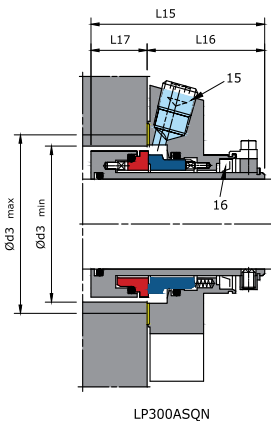
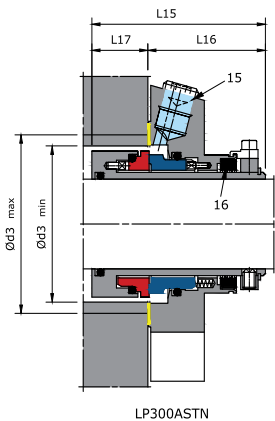

STANDARD STYLE

FACE MATERIAL

Silicon carbide, Carbon graphite resin impregnated, Tungsten carbide

METAL PARTS

SS 316, SS 304,

SECONDARY SEAL

EPDM, FKM, FFKM, PTFE

SEAL CHARACTERISTICS

- Single seal
- Available for standard (LP300-ASPN) and big bore (LP300-ABPN) seal chambers
- Cartridge
- Balanced
- Independent of direction of rotation
- Single seals with flush (-ASPN, -ABPN) and with quench combined with lip seal (-ASQN, -ABQN) or throttle ring (-ASTN, -ABTN)

APPLICATION

Shaft Diameter d_1 : 1.000" ... 3.750"
Pressure p : 25 bar
Temperature t : -40 +220°C
Velocity v : 16 m/sec

OPERATING LIMIT

- Process industry
- Petrochemical industry
- Chemical industry
- Pharmaceutical industry
- Power plant technology
- Pulp and paper industry
- Water and waste water technology
- Mining industry
- Food and beverage industry
- Universally applicable
- ANSI process pumps



SERIES ANSI LP300

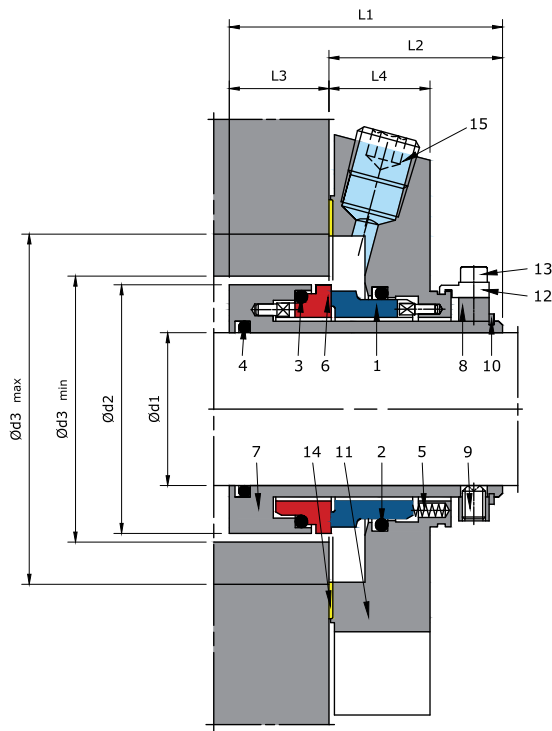

PART NO.	DESCRIPTION
1	SEAL FACE
2	O-RING
3	O-RING
4	O-RING
5	SPRING
6	SEAT
7	SHAFT SLEEVE
8	DRIVE COLLAR
9	SET SCREW
10	SNAP RING
11	COVER
12	ASSEMBLY FIXTURE
13	SCREW
14	GASKET
15	SCREW PLUG
16	LIP SEAL (-QN) THROTTLE RING (-TN)

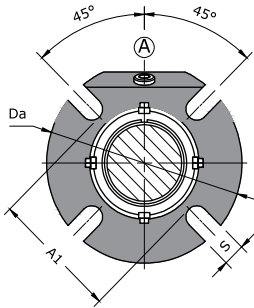

Machined cover version

Big bore - Dimensions in inch

SEAL SIZE +0.000 d1 -0.002	d2	d3min.	d3max.	L1	L2	L3	L4	L15	L16	L17	A1	Da	S	Connection
inch														
1.000	-	-	-	-	-	-	-	-	-	-	-	-	-	-
1.125	1.713	1.752	2.795	2.638	1.669	0.969	1.000	2.937	1.909	1.028	3.311	4.500	0.437	1/4 NPT
1.250	-	-	-	-	-	-	-	-	-	-	-	-	-	-
1.375	1.960	2.000	3.189	2.638	1.669	0.969	1.000	2.947	1.919	1.028	3.543	5.118	0.437	1/4 NPT
1.500	-	-	-	-	-	-	-	-	-	-	-	-	-	-
1.625	-	-	-	-	-	-	-	-	-	-	-	-	-	-
1.750	2.461	2.500	4.055	2.638	1.669	0.969	1.000	3.012	1.984	1.028	4.567	6.496	0.559	3/8 NPT
1.875	2.583	2.661	3.937	2.638	1.669	0.969	1.000	3.071	2.059	1.012	4.409	5.984	0.551	3/8 NPT
2.000	2.677	2.756	4.567	2.638	1.929	0.709	1.260	3.130	2.102	1.028	4.882	6.260	0.551	3/8 NPT
2.125	2.834	2.913	4.528	2.638	1.669	0.969	1.000	3.012	1.984	1.028	5.276	6.890	0.709	3/8 NPT
2.250	2.960	3.093	4.409	2.638	1.945	0.693	1.276	3.130	2.120	1.028	4.685	6.417	0.709	3/8 NPT
2.500	3.212	3.299	5.276	2.638	1.919	0.719	1.250	3.130	2.120	1.028	5.512	7.795	0.709	3/8 NPT
2.625	3.338	3.417	5.118	2.638	1.919	0.719	1.250	3.130	2.120	1.028	5.354	6.890	0.709	3/8 NPT
2.750	3.660	3.740	5.236	2.638	1.945	0.693	1.276	3.130	2.120	1.028	5.512	7.480	0.630	3/8 NPT
3.000	3.937	4.016	5.512	3.307	2.276	1.031	1.276	3.858	2.516	1.343	5.906	8.228	0.650	3/8 NPT
3.250	-	-	-	-	-	-	-	-	-	-	-	-	-	-

Standard bore - Dimensions in inch

SEAL SIZE +0.000 d1 -0.002	d2	d3min.	d3max.	L1	L2	L3	L4	L15	L16	L17	A1	Da	S	Connection
inch														
1.000	1.693	1.732	2.205	2.638	1.669	0.969	1.000	2.937	1.909	1.028	2.756	3.937	0.433	1/4 NPT
1.125	1.713	1.752	2.205	2.638	1.669	0.969	1.000	2.937	1.909	1.028	2.440	4.134	0.437	1/4 NPT
1.250	1.969	2.008	2.402	2.638	1.669	0.969	1.000	3.130	2.102	1.028	2.638	4.252	0.433	1/4 NPT
1.375	1.961	2.000	2.402	2.638	1.669	0.969	1.000	2.947	1.919	1.028	2.760	4.213	0.437	1/4 NPT
1.500	2.200	2.244	2.717	2.638	1.669	0.969	1.000	3.130	2.102	1.028	2.950	4.488	0.551	3/8 NPT
1.625	2.340	2.421	2.795	2.638	1.669	0.969	1.000	3.130	2.102	1.028	3.030	4.921	0.551	3/8 NPT
1.750	2.461	2.500	2.953	2.638	1.669	0.969	1.000	3.012	1.984	1.028	3.228	5.118	0.559	3/8 NPT
1.875	2.583	2.661	3.070	2.638	1.669	0.969	1.000	3.071	2.043	1.028	3.190	5.118	0.551	3/8 NPT
2.000	2.677	2.756	3.189	2.638	1.669	0.969	1.000	3.130	2.102	1.028	3.430	5.472	0.630	3/8 NPT
2.125	2.834	2.913	3.583	2.638	1.669	0.969	1.000	3.012	1.984	1.028	3820	5.512	0.650	3/8 NPT
2.250	2.960	3.039	3.583	2.638	1.669	0.969	1.000	3.130	2.102	1.028	3858	5.866	0.650	3/8 NPT
2.375	3.070	3.125	3.590	2.638	1.669	0.969	1.000	-	-	-	4.020	6.181	0.709	-
2.500	3.212	3.291	3.937	2.638	1.669	0.969	1.122	3.130	2.102	1.028	4.528	6.693	0.709	3/8 NPT
2.625	3.338	3.417	4.016	2.638	1.669	0.969	1.250	3.130	2.102	1.028	4.528	6.378	0.630	3/8 NPT
2.750	3.660	3.740	4.370	2.638	1.929	0.709	1.260	3.130	2.102	1.028	4.646	7.441	0.709	3/8 NPT
3.000	3.937	4.016	4.724	3.307	2.260	1.047	1.260	3.858	2.516	1.343	5.000	7.835	0.709	3/8 NPT
3.250	4.189	4.268	4.921	3.307	2.260	1.047	1.260	3.858	2.516	1.343	5.315	7.830	0.709	3/8 NPT
3.750	4.689	4.750	5.433	3.307	2.260	1.047	1.000	-	-	-	5.827	8.189	0.866	-



Follow us on



www.lineproofengg.com



LINEPROOF[®]
ENGINEERING INDIA PVT. LTD.



VASAI, Maharashtra, INDIA.



For Enquiries

sales.er@lineproofengg.com
lineproofengg@gmail.com



For Suggestions / Feedback

info@lineproofengg.com



Contact No.

+91 9726057335
+91 9819013772

we are loyal to our customers...

www.lineproofengg.com