



LINEPROOF[®]
ENGINEERING INDIA PVT. LTD.



SERIES LP98N



we are loyal to our customers...

www.lineproofengg.com



SERIES LP98N

Mechanical Seals / Mechanical Seals for Pump / Pusher Mechanical Seal



STANDARD STYLE

FACE MATERIAL

Silicon carbide, Carbon graphite

METAL PARTS

SS 316, SS 304,

SECONDARY SEAL

EPDM, NBR, FKM, FFKM

APPLICATION

- Chemical industry
- Pulp and paper industry
- Water and waste water technology
- Low solids content media (H17GN)
- Hot water
- Chemical standard pumps
- Water and sewage pumps

SEAL CHARACTERISTICS

- For Stepped shafts
- Single seal
- Balanced
- Dependent of direction of rotation
- Torque transmission via conical spring

OPERATING LIMIT

Shaft Diameter d1 : 10mm...80mm

Pressure p : 25 bar

Temperature t : -50 +220°C

Velocity v : 15 m/sec

G115

Cooled seat especially for hot water applications. In this case, the dimensions of the LP12N rotating unit are modified.

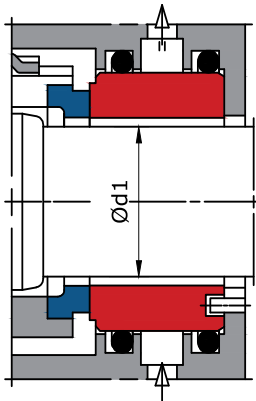

Seat alternatives

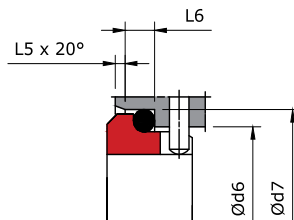

G16 (EN 12756 but l1k and l2 are shorter than specified)



SERIES LP98N

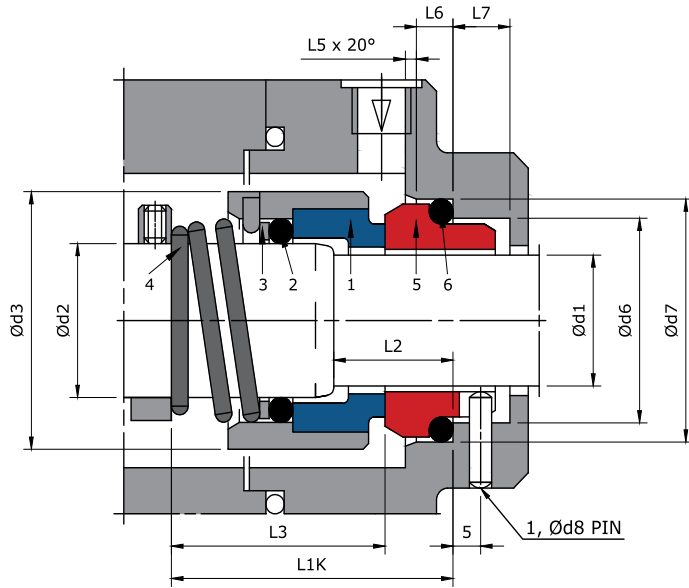

PART NO.	DESCRIPTION
1	SEAL FACE
2	O-RING
3	THRUST RING
4	RIGHT HAND SPRING
5	LEFT HAND SPRING
6	O-RING

SEAL SIZE $d1^{+0.00/-0.05}$ mm	d2	d3	d6 ^{H11}	d7 ^{H8}	d8	L2	L3	L5	L6	L7	L1K ^{±0.5}
10.0	14.0	24.0	17.0	21.0	3.0	18.0	25.5	1.5	4.0	8.5	35.5
12.0	16.0	26.0	19.0	23.0	3.0	18.0	26.5	1.5	4.0	8.5	36.5
14.0	18.0	31.0	21.0	25.0	3.0	18.0	29.5	1.5	4.0	8.5	39.5
16.0	20.0	34.0	23.0	27.0	3.0	18.0	31.0	1.5	4.0	8.5	41.0
18.0	22.0	36.0	27.0	33.0	3.0	20.0	32.5	2.0	5.0	9.0	44.0
20.0	24.0	38.0	29.0	35.0	3.0	20.0	32.5	2.0	5.0	9.0	44.0
22.0	26.0	40.0	31.0	37.0	3.0	20.0	32.5	2.0	5.0	9.0	44.0
24.0	28.0	42.0	33.0	39.0	3.0	20.0	32.5	2.0	5.0	9.0	44.0
25.0	30.0	44.0	34.0	40.0	3.0	20.0	33.5	2.0	5.0	9.0	45.0
28.0	33.0	47.0	37.0	43.0	3.0	20.0	35.5	2.0	5.0	9.0	47.0
30.0	35.0	49.0	39.0	45.0	3.0	20.0	35.5	2.0	5.0	9.0	47.0
32.0	38.0	54.0	42.0	48.0	3.0	20.0	39.5	2.0	5.0	9.0	51.0
33.0	38.0	54.0	42.0	48.0	3.0	20.0	39.5	2.0	5.0	9.0	51.0
35.0	40.0	56.0	44.0	50.0	3.0	20.0	43.5	2.0	5.0	9.0	55.0
38.0	43.0	59.0	49.0	56.0	4.0	23.0	46.0	2.0	6.0	9.0	60.0
40.0	45.0	61.0	51.0	58.0	4.0	23.0	48.0	2.0	6.0	9.0	62.0
43.0	48.0	64.0	54.0	61.0	4.0	23.0	51.0	2.0	6.0	9.0	65.0
45.0	50.0	66.0	56.0	63.0	4.0	23.0	55.0	2.0	6.0	9.0	69.0
48.0	53.0	69.0	59.0	66.0	4.0	23.0	55.0	2.0	6.0	9.0	69.0
50.0	55.0	71.0	62.0	70.0	4.0	25.0	58.0	2.5	6.0	9.0	73.0
53.0	58.0	78.0	65.0	73.0	4.0	25.0	60.0	2.5	6.0	9.0	75.0
55.0	60.0	79.0	67.0	75.0	4.0	25.0	60.0	2.5	6.0	9.0	75.0
58.0	63.0	83.0	70.0	78.0	4.0	25.0	60.0	2.5	6.0	9.0	75.0
60.0	65.0	85.0	72.0	80.0	4.0	25.0	60.0	2.5	6.0	9.0	75.0
63.0	68.0	88.0	75.0	83.0	4.0	25.0	60.0	2.5	6.0	9.0	75.0
65.0	70.0	90.0	77.0	85.0	4.0	25.0	61.0	2.5	6.0	9.0	76.0
70.0	75.0	98.0	83.0	92.0	4.0	28.0	63.0	2.5	7.0	9.0	81.0
75.0	80.0	103.0	88.0	97.0	4.0	28.0	68.0	2.5	7.0	9.0	86.0
80.0	85.0	109.0	95.0	105.0	4.0	28.0	68.0	3.0	7.0	9.0	86.0



Follow us on



www.lineproofengg.com

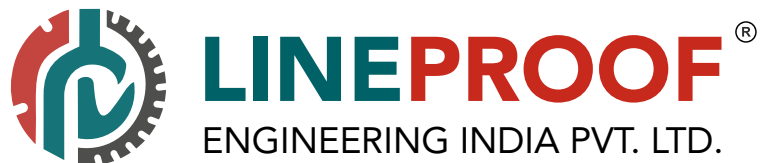

 **VASAI, Maharashtra, INDIA.**

 **For Enquiries**
sales.er@lineproofengg.com
lineproofengg@gmail.com

 **For Suggestions / Feedback**
info@lineproofengg.com

 **Contact No.**
+91 9726057335
+91 9819013772

we are loyal to our customers...

www.lineproofengg.com