



LINEPROOF[®]
ENGINEERING INDIA PVT. LTD.



SERIES LP305



we are loyal to our customers...

www.lineproofengg.com



SERIES LP305

Mechanical Seals / Mechanical Seals for Pump / Standard Cartridge Seals Mechanical Seal



STANDARD STYLE

FACE MATERIAL

Carbon graphite resin impregnated,
Silicon carbide

METAL PARTS

SS 316, SS 304,

SECONDARY SEAL

FKM, EPDM

SEAL CHARACTERISTICS

- Single cartridge seal
- Elastomer bellows
- Unbalanced
- Independent of direction of rotation
- Stationary seat, rotating spring
- Bellows and spring free from torsion
- Metric and inch sizes available

APPLICATION

- Chemical industry
- Pulp and paper industry
- Water and waste water technology
- Cold and hot water
- Cooling fluids
- Beverages
- Diluted lyes and acids
- Suspensions with low solids content
- Circulating pumps
- Water and waste water pumps
- Production of pressure oils for bio diesel fuels

OPERATING LIMIT

Shaft Diameter	d1	: 25mm...75mm
Pressure	p	: 12 bar
Temperature	t	: -20 +140°C
Velocity	v	: 10 m/sec



SERIES LP305

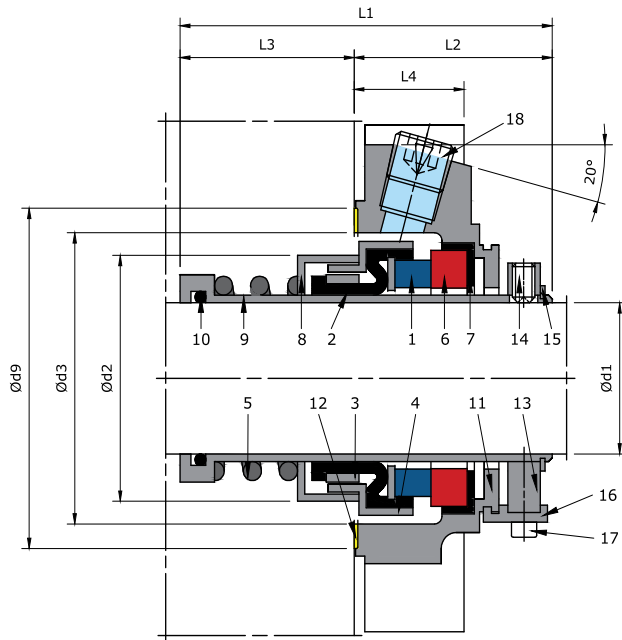

PART NO.	DESCRIPTION
1	SEAL FACE
2	BELLOWS
3	DRIVE COLLAR
4	"L"-RING (SPRING COLLAR
5	SPRING
6	SEAT
7	O-RING OR CORNER SLEEVE
8	SPACER RING
9	SHAFT SLEEVE
10	O-RING
11	COVER
12	GASKET
13	DRIVE COLLAR
14	SET SCREW
15	SNAP RING
16	ASSEMBLY FITURE
17	HSH CAP SCREW
18	SCREW PLUG

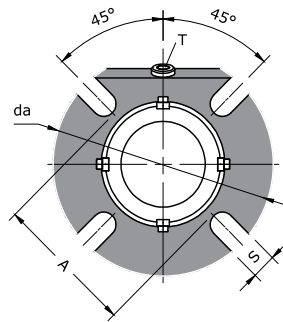

Seal cover

SEAL SIZE +0.00 d1-0.05	d2	d3 _{min.}	d3 _{max.}	d9	da	A	S	L1	L2	L3	L4	T
mm												
25.0	38.4	41.5	51.0	60.0	105.0	62.0	13.2	65.5	41.0	24.5	23.0	1/4 NPT
28.0	42.4	44.5	52.0	60.0	105.0	62.0	13.2	68.0	41.5	26.5	23.0	1/4 NPT
30.0	42.4	45.5	56.0	63.0	105.0	67.0	13.2	68.0	41.5	26.5	23.0	1/4 NPT
33.0	45.0	48.0	57.0	65.0	110.0	67.0	13.2	69.5	42.0	27.5	23.0	1/4 NPT
35.0	49.1	50.8	61.5	68.0	107.0	70.0	13.2	72.5	44.0	28.5	26.0	1/4 NPT
38.0	51.3	54.5	66.0	73.0	123.0	75.0	14.7	72.5	44.0	28.5	26.0	1/4 NPT
40.0	54.3	57.5	68.0	75.0	123.0	77.0	14.7	75.5	44.5	31.0	26.0	1/4 NPT
43.0	56.3	59.5	70.5	78.0	133.0	80.0	14.7	76.5	44.5	32.0	26.0	1/4 NPT
45.0	59.8	63.0	73.0	79.0	130.0	82.0	14.2	76.5	44.5	32.0	26.0	1/4 NPT
48.0	61.8	65.0	75.0	82.0	130.0	84.0	14.2	78.0	45.0	33.0	26.0	1/4 NPT
50.0	64.8	68.0	78.0	85.0	148.0	87.0	14.7	80.5	47.0	33.5	28.0	3/8 NPT
53.0	66.8	70.0	87.0	95.0	148.0	97.0	17.5	81.5	47.0	34.5	28.0	3/8 NPT
55.0	71.0	73.0	83.0	90.0	148.0	92.0	17.5	83.5	47.0	36.5	28.0	3/8 NPT
60.0	76.5	79.0	91.0	100.0	157.0	102.0	17.5	85.5	47.0	38.5	28.0	3/8 NPT
65.0	83.0	85.7	98.5	108.0	162.0	110.0	17.5	88.0	48.5	39.5	28.0	3/8 NPT
70.0	88.0	94.0	108.0	116.0	178.0	118.0	17.5	92.0	48.5	43.5	28.0	3/8 NPT
75.0	93.4	98.4	118.0	125.0	190.0	127.0	17.5	93.5	49.0	44.5	28.0	3/8 NPT



Follow us on



www.lineproofengg.com

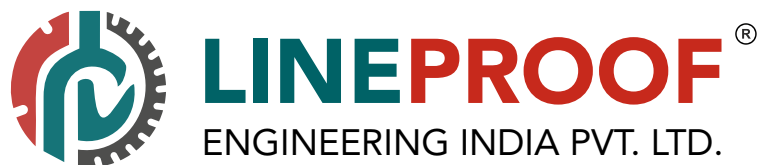

 **VASAI, Maharashtra, INDIA.**

 **For Enquiries**
sales.er@lineproofengg.com
lineproofengg@gmail.com

 **For Suggestions / Feedback**
info@lineproofengg.com

 **Contact No.**
+91 9726057335
+91 9819013772

we are loyal to our customers...

www.lineproofengg.com