



LINEPROOF[®]
ENGINEERING INDIA PVT. LTD.



SERIES LP200



we are loyal to our customers...

www.lineproofengg.com



SERIES LP200

Mechanical Seals / Mechanical Seals for Pump / Standard Cartridge Seals Mechanical Seal



STANDARD STYLE

FACE MATERIAL

Silicon carbide, Carbon graphite

METAL PARTS

SS 316, SS 304,

SECONDARY SEAL

EPDM, NBR, FKM, FFKM

SEAL CHARACTERISTICS

- Single seal
- Cartridge
- Balanced
- Independent of direction of rotation
- Single seals without connections (-SNO), with flush (-SN) and with quench combined with lip seal (-QN) or throttle ring (-TN)
- Additional variants available for ANSI pumps (e. g.-ABPN) and eccentric screw pumps (-Vario)

APPLICATION

- Process industry
- Petrochemical industry
- Chemical industry
- Pharmaceutical industry
- Power plant technology
- Pulp and paper industry
- Water and waste water technology
- Mining industry
- Food and beverage industry
- Sugar industry
- Universally applicable
- Centrifugal pumps
- Eccentric screw pumps
- Process pumps

OPERATING LIMIT

Shaft Diameter d1 : 25mm...100mm
 Pressure p : 25 bar
 Temperature t : -40 +220°C
 Velocity v : 16 m/sec

Product variants

LP200-SNO
 Single seal without connections, for dead-end operation.

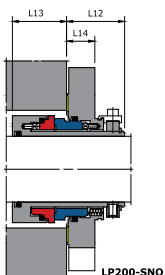

LP200-TN

Single seal, same as Cartex-SN but with throttle ring (item 16). The cover has auxiliary connections for flushing and quench. Throttle ring: PTFE carbon-graphite reinforced.

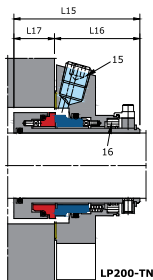

LP200-QN

Single seal for operation with unpressurized quench. Same as "-SN" version but with outboard lip seal (item 16). The cover has auxiliary connections for flushing and quench. Lip seal: NBR (P), PTFE carbon reinforced (T3).

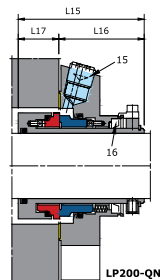



SERIES LP200

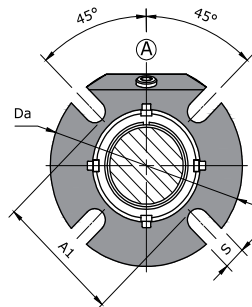
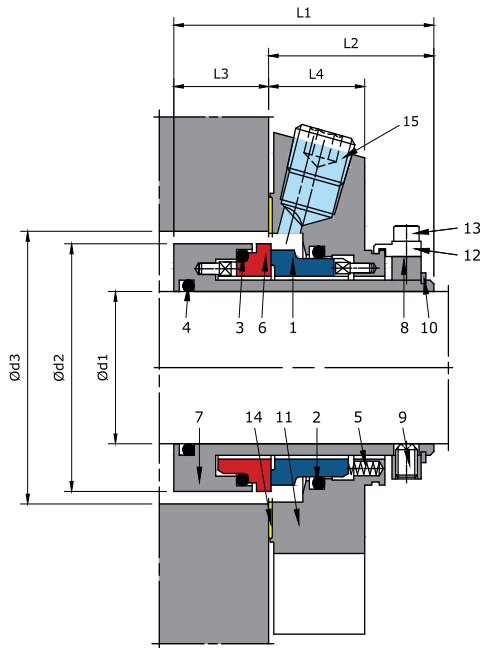

Machined cover version

PART NO.	DESCRIPTION
1	SEAL RING
2	O-RING
3	O-RING
4	O-RING
5	SPRING
6	SEAT
7	SHAFT SLEEVE
8	DRIVE COLLAR
9	SET SCREW
10	SNAP RING
11	HOUSING
12	ASSEMBLY FIXTURE
13	SCREW
14	GASKET
15	SCREW PLUG
16	LIP SEAL (-QN), THROTTLE RING (-TN)

SEAL SIZE $d1^{+0.00}_{-0.05}$	d2	d3min.	d3max.	L1	L2	L3	L4	L12	L13	L14	L15	L16	L17	A1	Da	S
mm																
25.0	43.0	44.0	51.5	67.0	42.4	24.6	25.4	35.0	32.0	17.5	79.5	53.4	26.1	62.0	105.0	13.2
28.0	46.0	47.0	52.0	67.0	42.4	24.6	25.4	35.0	32.0	17.5	79.5	53.4	26.1	62.0	105.0	13.2
30.0	48.0	49.0	56.0	67.0	42.4	24.6	25.4	35.0	32.0	17.5	79.5	53.4	26.1	65.0	105.0	13.2
32.0	49.8	51.0	57.0	67.0	42.4	24.6	25.4	35.0	32.0	17.5	79.5	53.4	26.1	67.0	108.0	13.2
33.0	49.8	51.0	57.0	67.0	42.4	24.6	25.4	35.0	32.0	17.5	79.5	53.4	26.1	67.0	108.0	13.2
35.0	53.0	54.0	61.5	67.0	42.4	24.6	25.4	35.0	32.0	17.5	79.5	53.4	26.1	70.0	113.0	13.2
38.0	56.0	57.0	66.0	67.0	42.4	24.6	25.4	35.0	32.0	17.5	79.5	53.4	26.1	75.0	123.0	13.2
40.0	58.0	59.0	68.0	67.0	42.4	24.6	25.4	35.0	32.0	17.5	79.5	53.4	26.1	75.0	123.0	14.2
42.0	60.5	61.5	69.5	67.0	42.4	24.6	25.4	35.0	32.0	17.5	79.5	53.4	26.1	80.0	133.0	14.2
43.0	60.5	61.5	70.5	67.0	42.4	24.6	25.4	35.0	32.0	17.5	79.5	53.4	26.1	80.0	133.0	14.2
45.0	62.5	64.0	73.0	67.0	42.4	24.6	25.4	35.0	32.0	17.5	79.5	53.4	26.1	81.0	138.0	14.2
48.0	65.6	67.0	75.0	67.0	42.4	24.6	25.4	35.0	32.0	17.5	79.5	53.4	26.1	84.0	138.0	14.2
50.0	68.0	69.0	78.0	67.0	42.4	24.6	25.4	35.0	32.0	17.5	79.5	53.4	26.1	87.0	148.0	14.2
53.0	72.0	73.0	87.0	67.0	42.4	24.6	25.4	35.0	32.0	17.5	79.5	53.4	26.1	97.0	148.0	18.0
55.0	73.0	74.0	83.0	67.0	42.4	24.6	25.4	35.0	32.0	17.5	79.5	53.4	26.1	90.0	148.0	18.0
60.0	78.0	79.0	91.0	67.0	42.4	24.6	25.4	35.0	32.0	17.5	79.5	53.4	26.1	102.0	157.0	18.0
65.0	84.8	85.7	98.5	67.0	42.4	24.6	25.4	35.0	32.0	17.5	79.5	53.4	26.1	109.0	163.0	18.0
70.0	93.0	95.0	108.0	67.0	42.4	24.6	25.4	35.0	32.0	17.5	79.5	53.4	26.1	118.0	178.0	18.0
75.0	100.0	101.6	118.0	84.0	57.4	26.6	28.0	46.1	37.9	22.0	98.0	63.9	34.1	129.0	190.0	18.0
80.0	106.4	108.0	124.0	84.0	57.4	26.6	28.0	46.1	37.9	22.0	98.0	63.9	34.1	135.0	195.0	18.0
85.0	109.5	111.1	128.0	84.0	57.4	26.6	28.0	46.1	37.9	22.0	98.0	63.9	34.1	139.0	198.0	22.0
90.0	115.9	117.5	135.0	84.0	57.4	26.6	28.0	46.1	37.9	22.0	98.0	63.9	34.1	145.0	205.0	22.0
95.0	119.1	120.7	138.0	84.0	57.4	26.6	28.0	46.1	37.9	22.0	98.0	63.9	34.1	148.0	208.0	22.0
100.0	125.4	127.0	144.0	84.0	57.4	26.6	28.0	46.1	37.9	22.0	98.0	63.9	34.1	154.0	218.0	22.0



Follow us on



www.lineproofengg.com

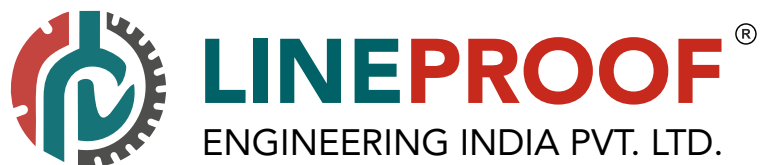

 **VASAI, Maharashtra, INDIA.**

 **For Enquiries**
sales.er@lineproofengg.com
lineproofengg@gmail.com

 **For Suggestions / Feedback**
info@lineproofengg.com

 **Contact No.**
+91 9726057335
+91 9819013772

we are loyal to our customers...

www.lineproofengg.com